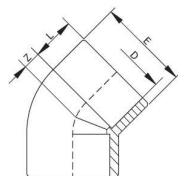
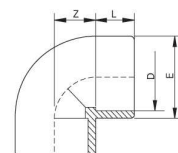
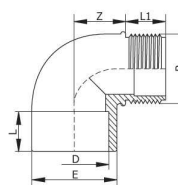

COT PVC PRESIUNE LA 45°
PVC Pressure elbow 45 degree

Cod articol	D (mm)	L (mm)	Z (mm)	E (mm)	PN (bar)
FVI0029	20	16	5	28	16
FVI0030	25	19	6	35	16
FVE0053	32	22	8	43	16
FVE0164	40	26	10	52	16
FVE0123	50	31	12	61	16
FVE0171	63	38	14	76	16
FVI0358	75	44	17	93	16
FVI0359	90	51	20	109	16
FVI0178	110	61	24	133	16
FVI0315	125	69	27	148	16
FVI0357	140	76	30	164	16
FVE0096	160	86	34	180	16
FVI0280	200	106	43	225	10

COT PVC PRESIUNE LA 90°
PVC Pressure elbow 90 degree

Cod articol	D (mm)	L (mm)	Z (mm)	E (mm)	PN (bar)
FVE0054	20	16	11	27	16
FVI0014	25	19	14	33	16
FVE0035	32	22	17	41	16
FVI0031	40	26	21	50	16
FVI0038	50	31	26	61	16
FVI0039	63	38	33	76	16
FVI0126	75	44	39	90	16
FVI0130	90	51	46	108	16
FVI0012	110	61	56	131	16
FVE0097	125	69	64	148	16
FVI0230	140	76	71	164	16
FVI0042	160	86	81	180	16
FVE0144	200	106	101	225	10

COT 90° MIXT: UN CAPĂT PRIN LIPIRE ȘI UNUL FE
PVC Pressure male threaded elbow 90 degree

Cod articol	D (mm)	L (mm)	Z (mm)	E (mm)	PN (bar)
FVE0054	20	16	11	27	16
FVI0014	25	19	14	33	16
FVE0035	32	22	17	41	16
FVI0031	40	26	21	50	16
FVI0038	50	31	26	61	16
FVI0039	63	38	33	76	16
FVI0126	75	44	39	90	16
FVI0130	90	51	46	108	16
FVI0012	110	61	56	131	16
FVE0097	125	69	64	148	16
FVI0230	140	76	71	164	16
FVI0042	160	86	81	180	16
FVE0144	200	106	101	225	10

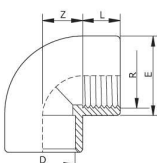
COT 90° MIXT: UN CAPĂT PRIN LIPIRE ȘI UNUL FI - cu inel de întărire
PVC Pressure female threaded elbow 90 degree - with reinforcement ring

Cod articol	D (mm)	L (inch)	Z (mm)	E (mm)	PN (bar)
FVI0306	20	1/2	16	11	16
FVI0352	25	3/4	19	14	16
FVI0375	32	1	22	17	16
FVI0378	40	1 ^{1/4}	26	21	16
FVI0410	50	1 ^{1/2}	31	26	16
FVI0376	63	2	38	33	16
FVI0377	75	2 ^{1/2}	44	40	16
FVI0380	90	3	51	48	16
FVI0412	110	4	61	58	16

COT 90° CU 2 CAPETE FI

PVC Pressure double female threaded elbow 90 degree



Cod articol	D (mm)	L (mm)	Z (mm)	E (mm)	PN (bar)
FVI0384	1/2	16	11	28	16
FVI0381	3/4	19	14	34	16
FVI0382	1	22	17	43	16
FVI0281	1 ^{1/4}	26	21	54	16
FVI0365	1 ^{1/2}	31	26	63	16
FVI0368	2	38	33	78	16
FVI0369	2 ^{1/2}	30	54	89	16
FVI0269	3	33	66	106	16
FVI0367	4	39	80	129	16

MUFĂ PVC PRESIUNE 2 CAPETE PRIN LIPIRE

PVC Pressure coupler

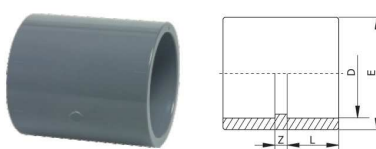

Cod articol	D (mm)	L (mm)	Z (mm)	E (mm)	PN (bar)
FVI0384	1/2	16	11	28	16
FVI0381	3/4	19	14	34	16
FVI0382	1	22	17	43	16
FVI0281	1 ^{1/4}	26	21	54	16
FVI0365	1 ^{1/2}	31	26	63	16
FVI0368	2	38	33	78	16
FVI0369	2 ^{1/2}	30	54	89	16
FVI0269	3	33	66	106	16
FVI0367	4	39	80	129	16

Niplu redus PVC presiune cu filet exterior

PVC pressure nipple male threaded

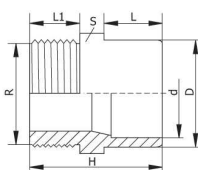

Cod articol	D (mm)	R (inch)	L (mm)	L1 (mm)	H (mm)	S (mm)	PN (bar)
FVI0294	25/20	1/2	19	14	45	5	16
FVI0461	25/20	3/4	19	16	47	6	16
FVI0462	32/25	1/2	22	14	49	6	16
FPI0223	32/25	3/4	22	16	51	8	16
FVI0433	32/25	1	22	19	54	8	16
FVI0448	40/32	1/2	26	13	-	8	16
FVI0449	40/32	3/4	26	16	55	10	16
FVI0446	40/32	1	26	19	58	11	16
FVI0054	40/32	1 ^{1/4}	26	21	60	11	16
FVI0450	50/40	1	31	19	64	11	16
FVI0105	50/40	1 ^{1/4}	31	21	66	11	16
FVI0243	50/40	1 ^{1/2}	31	25	70	11	16
FVI0339	63/50	1	38	19	-	12	16
FVI0180	63/50	1 ^{1/4}	38	21	73	12	16
FVI0181	63/50	1 ^{1/2}	38	21	73	12	16
FVI0237	63/50	2	38	25	78	12	16
FVI0362	75/63	1 ^{1/4}	44	17	-	19	16
FVI0366	75/63	1 ^{1/2}	44	21	80	19	16
FVI0451	75/63	2	44	25	84	19	16
FVI0152	75/63	2 ^{1/2}	44	30	89	19	16
FVI0372	90/75	2	51	25	91	25	16
FVI0344	90	2 ^{1/2}	61	30	106	31	16
FVI0452	90/75	2 ^{1/2}	51	30	96	25	16
FVE0143	90/75	3	51	33	99	25	16
FVI0274	110	3	61	33	109	31	16
FVE0087	110	4	61	40	116	31	16
FVI0349	110/90	3	61	33	109	25	16
FVI0308	110/90	4	61	40	116	25	16

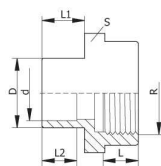

Niplu redus PVC presiune cu filet interior
PVC pressure nipple female threaded

Cod articol	D (mm)	R (inch)	L (mm)	L1 (mm)	L2 (mm)	S (mm)	PN (bar)
FVE0224	20	1/2	17	16	14	5	16
FVI0312	25	1/2	18	19	16	5	16
FVE0225	25	3/4	18	19	16	5	16
FVI0379	32	1/2	18	22	19	6	16
FVI0431	32	3/4	18	22	19	8	16
FVI0188	32	1	22	22	19	2	16
FVI0478	40	1	23	26	22	3	16
FVI0106	40	1 1/4	23	26	22	3	16
FVI0107	50	1 1/4	25	31	26	4	16
FVI0459	50	1 1/2	25	31	26	4	16
FVI0456	63	1 1/2	28	38	31	4,7	16
FVI0114	63	2	28	38	31	4,7	16
FVI0460	75	2 1/2	33	44	38	3	16
FPI0163	90	3	36	51	44	3	16
FVI0463	110	4	45	61	51	5	16

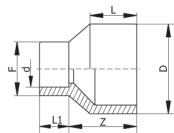
Niplu redus PVC presiune - lipire
PVC pressure reduced nipple - glue

Cod articol	D (mm)	d (inch)	L (mm)	L1 (mm)	Z (mm)	F (mm)	PN (bar)
FVE0050	32/25	20	26	16	30	27	16
FVI0271	32/25	25	26	16	30	33	16
FVI0273	40/32	20	26	19	36	27	16
FVI0268	40/32	25	31	16	36	33	16
FVI0259	40/32	32	26	22	36	38	16
FVI0266	50/40	20	31	16	44	27	16
FVI0254	50/40	25	31	19	44	33	16
FVI0255	50/40	32	31	22	44	41	16
FVE0121	50/40	⁴⁰	31	26	44	48	16
FVI0261	63/50	²⁰	38	19	54	27	16
FVI0265	63/50	²⁵	38	19	54	33	16
FVI0192	63/50	³²	38	22	54	41	16
FVI0361	63/50	40	38	26	54	50	16
FVI0284	63/50	50	38	31	54	61	16
FVI0267	75/63	20	44	-	62	-	16
FVI0270	75/63	25	44	-	62	-	16
FVI0292	75/63	32	44	22	62	41	16
FVI0264	75/63	40	44	26	62	50	16
FVI0262	75/63	50	44	31	62	61	16
FVI0302	75/63	63	44	38	62	73	16
FVI0429	90/75	40	51	26	74	50	16
FVI0316	90/75	50	51	31	74	61	16
FVI0279	90/75	63	51	38	74	75	16
FVI0282	90/75	75	51	44	74	87	16
FVI0432	110/90	50	61	31	88	61	16
FVI0275	110/90	63	61	38	88	75	16
FVI0278	110/90	75	61	44	88	90	16
FVI0277	110/90	90	61	51	88	105	16
FVI0355	125/110	63	69	38	100	75	16
FVI0253	125/110	75	69	44	100	90	16
FVI0272	125/110	90	69	51	100	105	16
FVI0256	140/125	110	76	44	111	132	16
FVI0260	140/125	75	76	51	111	105	16
FVI0258	140/125	90	76	61	111	90	16
FVI0323	160/140	110	86	51	126	105	10
FVI0310	160/140	125	86	61	126	130	10
FVI0257	160/140	90	86	69	126	148	10
FVI0317	200/180	110	106	61	154	130	10
FVI0301	200/180	125	106	69	154	148	10

Niplu redus PVC presiune - lipire

PVC pressure reduced nipple - glue

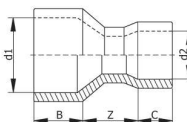

Cod articol	d1/d2 (mm)	Z (mm)	B (mm)	C (mm)	PN (bar)
FVI0393	63/50	32	40	33	16
FVI0457	75/50	37	46	33	16
FVI0437	75/63	33	46	40	16
FVI0440	90/50	35	53	33	16
FVI0203	90/63	55	53	40	16
FVI0494	90/75	40	53	46	16
FVI0444	110/75	65	64	46	16
FVI0441	110/90	60	64	53	16
FVI0442	125/90	70	72	53	16
FPI0165	125/110	60	72	64	16
FVI0436	140/110	55	80	64	16
FVI0425	140/125	65	80	72	16
FVI0428	160/110	95	90	64	16
FVI0360	160/125	80	90	72	16
FVI0495	160/140	70	90	80	16
FVI0427	200/125	120	111	72	10
FVI0430	200/140	115	111	80	10
FVE0146	200/160	100	111	90	10

REDUCȚIE SCURTĂ 2 CAPETE PRIN LIPIRE

PVC pressure short reduction

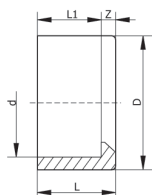

Cod articol	D (mm)	L (mm)	L1 (mm)	PN (bar)
FVI0304	20/16	16	14	16
FVI0336	25/16	19	14	16
FVI0458	25/20	19	16	16
FVI0335	32/16	22	14	16
FVI0127	32/20	22	16	16
FVI0027	32/25	22	19	16
FVI0334	40/16	26	14	16
FVI0333	40/20	26	16	16
FVI0464	40/25	26	19	16
FVI0028	40/32	26	22	16
FVI0276	50/20	31	16	16
FVI0293	50/25	31	19	16
FVI0288	50/32	31	22	16
FVI0299	50/40	31	26	16
FVI0483	63/25	38	19	16
FPI0222	63/32	38	22	16
FVI0296	63/40	38	26	16
FVI0148	63/50	38	31	16
FVI0383	75/32	44	22	16
FVI0295	75/40	44	26	16
FVI0286	75/50	44	31	16
FVE0120	75/63	44	38	16
FVI0454	90/50	51	31	16
FVE0152	90/63	51	38	16
FVE0119	90/75	51	44	16
FVI0325	110/50	61	31	16
FVI0204	110/63	61	38	16
FVI0219	110/75	61	44	16
FVI0076	110/90	61	51	16
FVI0309	110/100	61	56	16
FVI0465	125/75	69	44	16
FVI0303	125/90	69	51	16
FVI0186	125/110	69	61	16
FVI0314	140/75	76	44	16
FVI0434	140/90	76	51	16
FVI0229	140/110	76	61	16
FVI0311	140/125	76	69	16
FVE0147	160/90	86	51	16
FVE0148	160/110	86	61	16
FVI0075	160/125	86	69	16
FVI0300	160/140	86	76	16
FVI0307	200/140	-	-	10

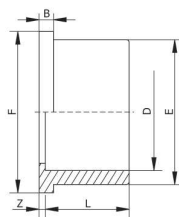

ADAPTOR PENTRU FLANȘĂ PVC PRESIUNE
PVC pressure flange adaptor

Cod articol	D (mm)	L (mm)	F (mm)	B (mm)	Z (mm)	PN (bar)
FVI0328	20	16	34	6	3	16
FVI0198	25	19	41	7	3	16
FVI0231	32	22	50	7	3	16
FVI0326	40	26	60	8	3	16
FVI0142	50	31	72	8	3	16
FVI0182	63	38	90	9	3	16
FVI0170	75	44	106	10	3	16
FVI0177	90	51	125	11	5	16
FVI0078	110	61	150	12	5	16
FVI0079	125	69	170	13	5	16
FVI0153	140	76	188	14	5	16
FVI0171	160	86	212	16	5	16
FVI0172	200	106	248	19	7	10

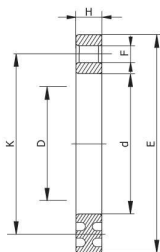
FLANȘĂ PVC PRESIUNE
PVC pressure flange

Cod articol	D (mm)	E (mm)	H (mm)	K (mm)	F (mm)	PN (bar)
FVI0503	20	95	11	65	14x4	16
FVI0250	25	105	12	75	14x4	16
FVI0129	32	115	14	85	14x4	16
FVI0319	40	140	15	100	18x4	16
FVE0116	50	150	16	110	18x4	16
FVI0155	63	165	18	125	18x4	16
FVI0065	75	185	19	145	18x4	16
FVE0117	90	200	20	160	18x8	16
FVE0118	110	220	22	180	18x8	16
FVI0049	125	235	26	190	18x8	16
FVI0154	140	240	26	210	18x8	16
FVI0048	160	280	26	240	22x8	10
FVE0149	200	315	28	270	22x8	10

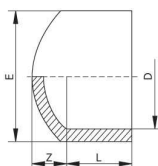
DOP PVC PRESIUNE
PVC pressure end cap

Cod articol	D (mm)	L (mm)	Z (mm)	E (mm)
FVI0338	20	16	8	25
FVI0140	25	19	9	32
FVI0125	32	22	10	40
FVI0370	40	26	12	50
FVI0242	50	31	15	63
FVI0238	63	38	17	75
FVI0332	75	44	19	90
FVI0285	90	51	23	110
FVI0341	110	61	28	131
FVE0162	125	69	32	148
FVI0331	140	76	36	167
FVI0283	160	86	40	185
FVI0329	200	106	46	224

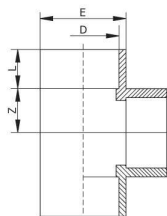
TEU PVC PRESIUNE
PVC pressure Tee

Cod articol	D (mm)	L (mm)	Z (mm)	E (mm)	PN (bar)
FVE0051	20	16	11	27	16
FVI0013	25	19	14	33	16
FVE0124	32	22	17	41	16
FVE0155	40	26	21	50	16
FVE0086	50	31	26	63	16
FVI0151	63	38	33	78	16
FVI0213	75	44	39	90	16
FVE0098	90	51	46	108	16
FVI0176	110	61	56	131	16
FVE0099	125	69	64	148	16
FVI0241	140	76	71	164	16
FVE0100	160	86	81	186	16
FVE0145	200	106	101	228	10

Teu redus PVC presiune

PVC pressure reduced Tee 90 degree

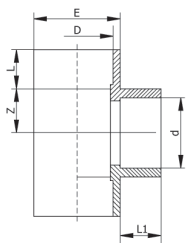

Cod articol	D (mm)	L (mm)	L1 (mm)	Z (mm)	E (mm)	PN (bar)
FVI0084	25x20	19	16	14	33	16
FVI0290	32x20	22	16	17	41	16
FVI0236	32x25	22	19	17	41	16
FVI0467	40x20	26	16	21	50	16
FVI0477	40x25	26	19	21	50	16
FVI0189	40x32	26	22	21	50	16
FVI0298	50x20	31	16	26	61	16
FVI0484	50x25	31	19	26	61	16
FVE0163	50x32	31	22	26	61	16
FVI0112	50x40	31	26	26	61	16
FVI0481	63x20	38	16	32	76	16
FVI0249	63x25	38	19	32	76	16
FVI0190	63x32	38	22	32	76	16
FVI0223	63x40	38	26	32	76	16
FVI0468	63x50	38	31	32	76	16
FVI0469	75x32	44	22	38	90	16
FVI0466	75x40	44	26	38	90	16
FVI0337	75x50	44	31	38	90	16
FVI0470	75x63	44	38	38	90	16
FVI0205	90x32	51	22	46	108	16
FVI0473	90x40	51	26	46	108	16
FVI0408	90x50	51	31	46	108	16
FVI0135	90x63	51	38	46	108	16
FVI0471	90x75	51	44	46	108	16
FVI0472	110x32	61	22	56	131	16
FVE0137	110x50	61	31	56	131	16
FVI0074	110x63	61	38	56	131	16
FVI0498	110x75	61	44	56	131	16
FVI0374	110x90	61	51	56	131	16
FVI0245	125x50	69	31	63	149	16
FVI0072	125x63	69	38	63	149	16
FVI0212	125x75	69	44	63	149	16
FVI0475	125x90	69	51	63	149	16
FVI0287	125x110	69	61	63	149	16
FVI0496	140x50	76	31	71	162	16
FVI0497	140x75	76	44	71	162	16
FVI0415	140x90	76	51	71	162	16
FVI0500	140x110	76	61	71	162	16
FVI0321	140x125	76	69	71	162	16
FVI0073	160x90	86	51	81	186	16
FVI0364	160x110	86	61	81	186	16
FVI0501	160x125	86	69	81	186	16
FVI0502	160x140	86	76	81	186	16
FVI0485	200x110	107	61	106	-	16
FVI0453	200x160	107	81	106	-	16

TEU EGAL PVC PRESIUNE 45° - 3 CAPETE PRIN LIPIRE

PVC pressure equal Tee 45 degree

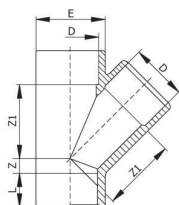

Cod articol	D (mm)	L (mm)	L1 (mm)	Z (mm)	E (mm)	PN (bar)
FVI0488	20	16	29,5	6	16	16
FVI0489	25	19	35,5	7,5	16	16
FVI0025	32	22	44,5	9	22	16
FVI0026	40	26	56	10	26	16
FVI0424	50	31	69	12	31	16
FVE0172	63	38	86	14	38	16
FVI0486	75	44	102	17	44	16
FVI0487	90	51	121	20	51	16
FVI0120	110	61	148	24	61	16
FVI0435	125	-	167	30	69	16
FVI0443	140	-	190	34	76	16
FVI0318	160	-	211	35	86	10
FVI0491	200	-	266	49	107	10

ȚEVI ȘI FITINGURI DIN PVC DE PRESIUNE

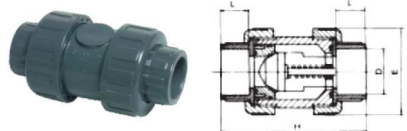

INFRASTRUCTURĂ - UTILITĂȚI

SUPAPĂ SENS PVC
PVC pressure Backflow valve

Cod articol	D (mm)	DN (mm)	L (mm)	H (mm)	E (mm)	PN (bar)
FVI0291	20	15	16	84	52	16
FVI0342	25	20	19	108	62	16
FVI0479	32	25	22	124	70	16
FVI0297	40	32	26	142	84	16
FVI0504	50	40	31	167	104	16
FVI0343	63	50	38	198	120	16
FVI0356	75	65	44	232	148	10
FVI0184	90	80	51	269	179	10
FVI0474	110	80	61	279	179	10

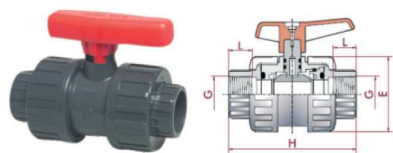
ROBINET PVC CU BILĂ TIP MEGA CU FILET
PVC pressure Ball valve - Mega type - threaded

Cod articol	G (inch)	DN (mm)	H (mm)	L (mm)	E (mm)	PN (bar)
FVI0201	1/2	16	84	14	52	16
FVI0022	3/4	20	111	28	65	16
FVI0019	1	25	113	29	65	16
FVI0020	1 1/4	32	146	35	90	16
FVI0313	1 1/2	40	148	36	90	16
FVI0227	2	50	168	44	111	16
FVI0215	2 1/2	63	238	47	168	16
FVE0259	3	75	242	55	168	10
FVE0258	4	90	275	61	179	10

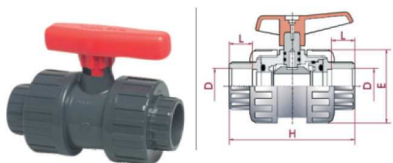
ROBINET PVC CU BILĂ TIP MEGA
PVC pressure Ball valve - Mega type

Cod articol	D (mm)	DN (mm)	L (mm)	H (mm)	E (mm)	PN (bar)
FVI0018	20	15	84	16	52	16
MFD0025	25	20	111	28	65	16
FVE0049	32	25	113	29	65	16
MFD0026	40	32	146	35	90	16
FVI0150	50	40	148	36	90	16
FVI0058	63	50	168	44	111	16
FVI0220	75	63	238	47	168	10
FVI0183	90	80	242	55	168	10
FVI0179	110	90	275	-	-	10

ROBINET PVC FLUTURE FĂRĂ FLANȘE
PVC pressure butterfly valve

Cod articol	D (mm)	PN (bar)
FVI0371	63/75	16
FVI0476	90	16
FVI0289	110	16
FVI0322	125	16
FVI0324	140	16
FVI0263	160	10
FVI0330	200	10
FVI0445	225	10
FVI0252	250	10

RACORD OLANDEZ 2 CAPETE PRIN LIPIRE

PVC pressure screwed union

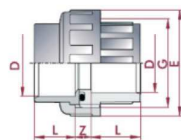

Cod articol	D (mm)	L (mm)	Z (mm)	G (inch)	E (mm)	PN (bar)
FVI0398	20	16	13	1	41	16
FVI0480	25	19	13	1 ^{1/4}	52	16
FVI0399	32	22	13	1 ^{1/2}	60	16
FVI0414	40	26	15	2	74	16
FVI0396	50	31	17	2 ^{1/4}	80	16
FVI0397	63	38	21	2 ^{3/4}	99	16
FVI0400	75	44	21	3 ^{1/2}	120	10
FVI0417	90	51	24	4	138	10
FVI0404	110	61	26	5 ^{1/2}	179	10

RACORD OLANDEZ MIXT UN CAPĂT PRIN LIPIRE ȘI UN CAPĂT FI

PVC pressure screwed union - female threaded

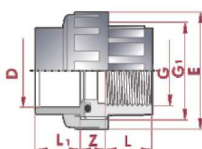

Cod articol	D (mm)	G (inch)	L (mm)	L1 (mm)	Z (mm)	G1 (inch)	E (mm)	PN (bar)
FVI0401	20	1/2	16	16	13	1	41	16
FVI0402	25	3/4	19	19	13	1 ^{1/4}	52	16
FVI0493	32	1	22	22	13	1 ^{1/2}	60	16
FVI0385	40	1 ^{1/4}	26	26	15	2	74	16
FVI0388	50	1 ^{1/2}	31	31	17	2 ^{1/2}	80	16
FVI0389	63	2	38	38	21	2 ^{3/4}	99	16
FVI0340	75	2 ^{1/2}	44	44	21	3 ^{1/2}	120	10
FVI0386	90	3	51	51	24	4	138	10
FVI0447	110	4	61	61	26	5 ^{1/2}	179	10

RACORD OLANDEZ MIXT UN CAPĂT PRIN LIPIRE ȘI UN CAPĂT FE

PVC pressure screwed union - male threaded

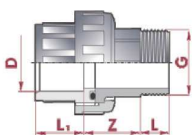

Cod articol	D (mm)	G (inch)	L (mm)	L1 (mm)	Z (mm)	PN (bar)
FVI0390	20	1/2	15	16	33	16
FVI0439	25	3/4	16	19	35	16
FVI0394	32	1	19	22	40	16
FVI0391	40	1 ^{1/4}	21	26	40	16
FVI0387	50	1 ^{1/2}	21	31	48	16
FVI0392	50	2	24	34	54	16
FVI0418	63	2	28	38	62	16
FVI0419	75	2 ^{1/2}	30	44	70	10
FVI0416	90	3	33	51	62	10
FVI0305	110	4	40	61	70	10

RACORD OLANDEZ CU FILET 2 X FI

PVC pressure screwed union - double female threaded

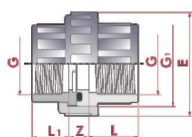

Cod articol	G (inch)	L (mm)	L1 (mm)	Z (mm)	G1 (mm)	E (mm)	PN (bar)
FVI0406	1/2	16	15	12	1	41	16
FVI0407	3/4	19	17	12	1 ^{1/4}	52	16
FVI0499	1	22	20	14	1 ^{1/2}	60	16
FVI0395	1 ^{1/4}	26	24	16	2	74	16
FVI0413	1 ^{1/2}	31	25	18	2 ^{1/4}	80	16
FVI0482	2	38	29	20	2 ^{3/4}	99	16
FVI0455	2 ^{1/2}	44	34	21	3 ^{1/2}	120	10
FVI0411	3	51	37	24	4	138	10
FVI0403	4	61	42	26	5 ^{1/2}	179	10

RACORD OLANDEZ CU FILET FI X FE

PVC pressure screwed union - male - female threaded

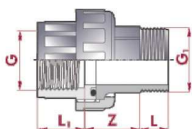

Cod articol	R (inch)	L (mm)	L1 (mm)	Z (mm)	PN (bar)
FVI0420	1/2 x 1/2	15	16	33	16
FVI0423	3/4 x 3/4	16	19	35	16
FVI0490	1 x 1	19	22	40	16
FVI0345	1 ^{1/4} x 1 ^{1/4}	21	26	40	16
FVI0422	1 ^{1/2} x 1 ^{1/2}	21	31	48	16
FVI0320	2 x 2	28	38	62	16
FVI0409	2 ^{1/2} x 2 ^{1/2}	30	44	70	10
FVI0421	3 x 3	33	51	62	10
FVI0405	4 x 4	40	61	70	10

